

AURORA

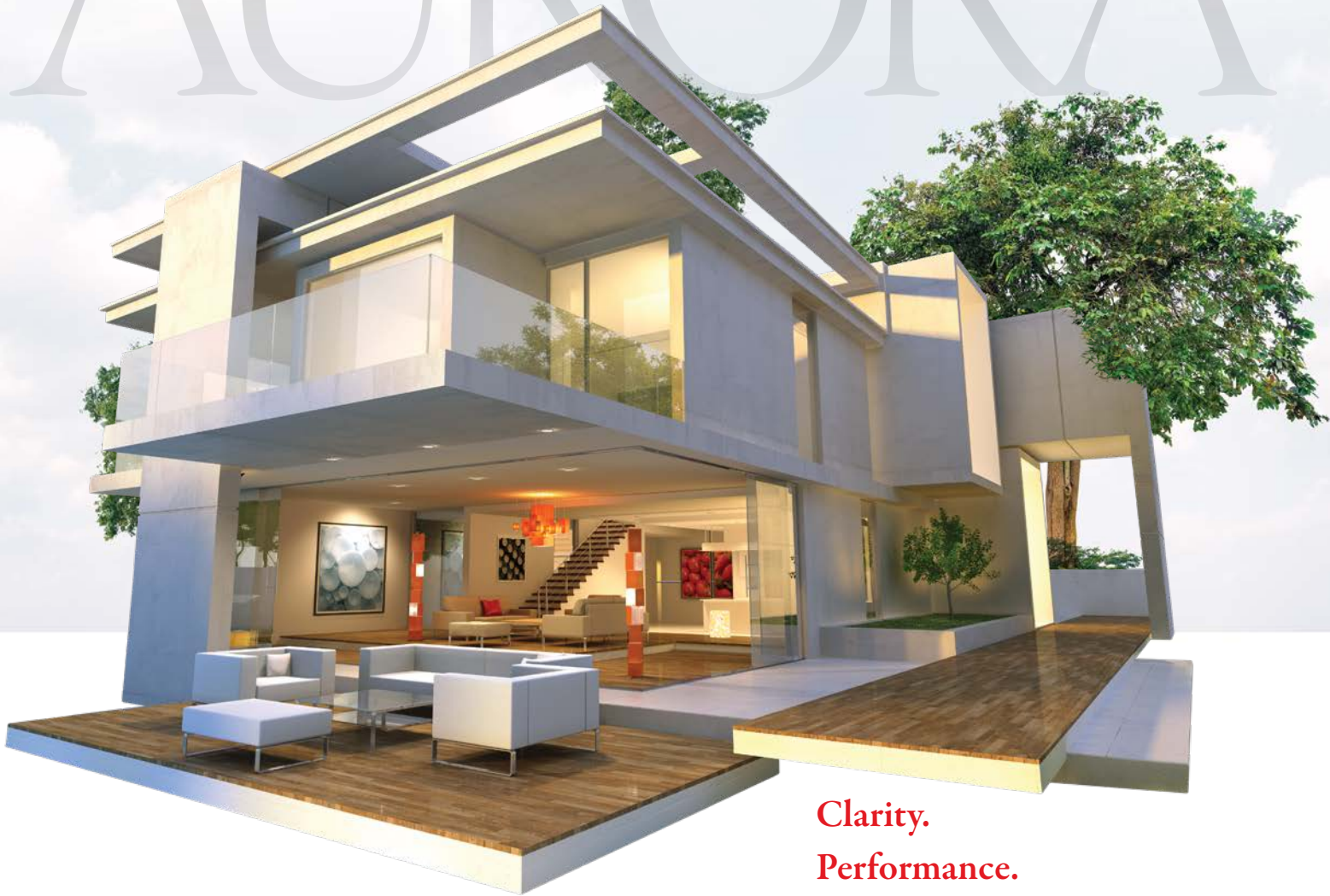

Clarity.
Performance.
Elegance.



Clarity. Performance. Elegance.

The most elegant architectural film on the market, ASWF's Aurora series is sure to make a lasting impression. With a proprietary, multi-stacked, sputtered technology, Aurora delivers unparalleled performance.

Aurora, with its unmatched HD clarity and an unprecedented 97% Infrared (IR) rejection, elegantly provides a cool and comfortable environment, unlike any other window film.

Aurora 35

| | |
|------------------------------------|------|
| % Total Solar | |
| Reflectance (Rsol Exterior) | 32 |
| Absorption | 48 |
| Transmission (Tsol)) | 20 |
| % Visible light | |
| Transmittance (VLT) | 36 |
| VLR Interior | 7 |
| VLR Exterior | 9 |
| Ultraviolet rejection (UV) | 99.9 |
| Glare reduction | 60 |
| Shading Coefficient (SC) | 38 |
| Solar heat gain Coefficient (SHGC) | 33 |
| Infrared Rejection (IR) | |
| .78-2.25 nm | 97 |
| Total Solar Energy Rejected (TSER) | 67 |



Aurora 45

| | |
|------------------------------------|------|
| % Total Solar | |
| Reflectance (Rsol Exterior) | 33 |
| Absorption | 44 |
| Transmission (Tsol)) | 23 |
| % Visible light | |
| Transmittance (VLT) | 45 |
| VLR Interior | 8 |
| VLR Exterior | 9 |
| Ultraviolet rejection (UV) | 99.9 |
| Glare reduction | 51 |
| Shading Coefficient (SC) | 40 |
| Solar heat gain Coefficient (SHGC) | 34 |
| Infrared Rejection (IR) | |
| .78-2.25 nm | 97 |
| Total Solar Energy Rejected (TSER) | 66 |

Vision. Comfort. Protection.

BACKED BY A LIFETIME FACTORY WARRANTY

MADE IN LAS VEGAS, USA

AURORA
Select
D E A L E R



www.aswf.com

3135 Marco Street, Las Vegas, Nevada 89115

tel.800.835.9676

fax.702.643.0509

A division of Erickson International LLC.

Erickson International is the manufacturer of ASWF brand window films. Our manufacturing facility is located in Las Vegas, Nevada and is the newest in the window film industry. Although our facility and machines are new, we have engaged experienced technicians with vast experience to produce our multiple lines of window films.